

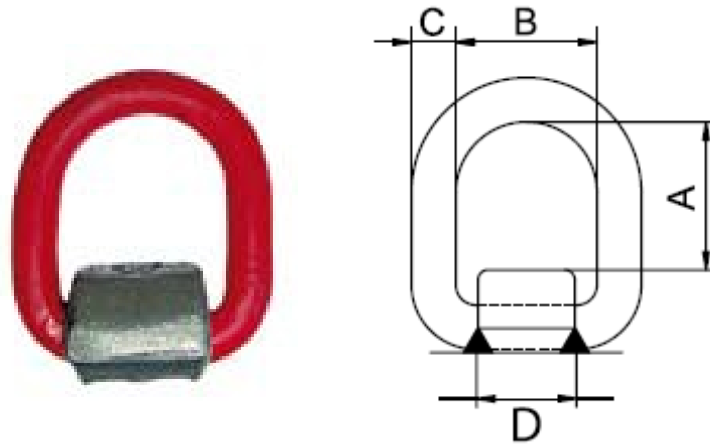

Weld-on transport ring

- **Material** : base: mild steel, ring: alloy steel
- **Safety factor** : MBL equals 4 x WLL
- **Finish** : painted red
- **Certification** : at no extra charge this product can be supplied with a works certificate and/or EC Declaration of Conformity
- **Note** : Welding must be done in accordance with DIN 8563 resp. 15429, by a qualified welder according to EN 287-1



Dimensions table

Code	LC	Dimensions in mm				BF	Weight
		A	B	C	D		
PAS 1	1.20	42	40	13	35	4.8	0.40
PAS 3	3.20	48	45	18	42	12.8	0.70
PAS 5	5.30	57	55	22	49	21.2	1.20
PAS 8	8.00	67	70	26	64	32.0	2.40
PAS 15	15.00	93	97	34	86	60.0	5.90