

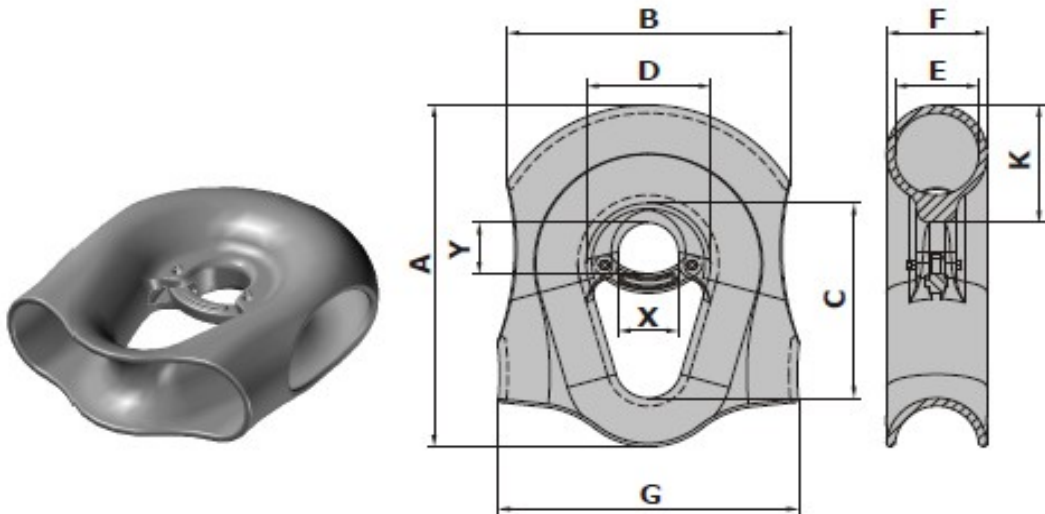

CAST THIMBLE TYPE K14

- Material: - Cast steel
 - Stainless steel
 Finish: Galvanised (mild steel)
 Self coloured (stainless steel)
 Plastic coating on request



Art. no. steel	Art. no. stainl. steel	Rope size Inch	A mm	B mm	C mm	D mm	E mm	F mm	G mm	K mm	X mm	Y mm	Weight Kg
16001113	21001113	11"-13"	540	330	330	170	120	160	476	175	105	85	40
16001415	21001415	14"-15"	655	480	367	252	150	183	607	200	116	124	78
16001618	21001618	16"-18"	795	551	420	280	187	212	724	254	136	128	115
16001921	21001921	19"-21"	940	665	497	335	215	267	875	309	150	180	296
16002224	21002224	22"-24"	1052	715	650	420	250	300	895	362	180	200	385

Tolerance \pm 5%